

# HOW TO USE SAWGRASS SG500 SUBLIMATION PRINTER

## PRODUCTS FOR SUBLIMATION:



Ceramic mug - max. print size 200x80 mm,  
heat press temp. 180 C°, time 180 sec.



Enamel mug - max. print size 200x60 mm,  
heat press temp. 200 C°, time 275 sec.



Mouse pad - actual size 230x190x5 mm,  
print size 235x195 mm,  
heat press temp. 200 C°, time 40 sec.



Key chain - actual size 22x125 mm (one side),  
print size 27x270 mm (both sides),  
heat press temp. 200 C°, time 40 sec.



Patch - diameter 80 mm with the border  
and 75 mm printing area.  
Heat press temp. 200 C°, time 40 sec.

Use for example Illustrator or Inkscape to prepare your A4 size layout (remember to leave 5 mm margin on the edges) and save it in pdf. -form.

Then open PrintMate software and follow these steps.

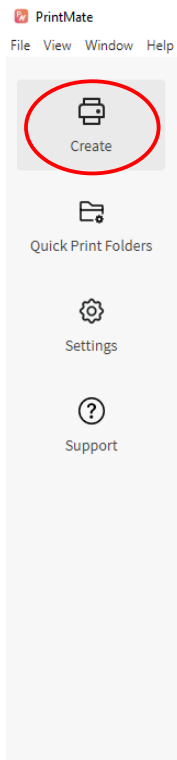

Click here to get started

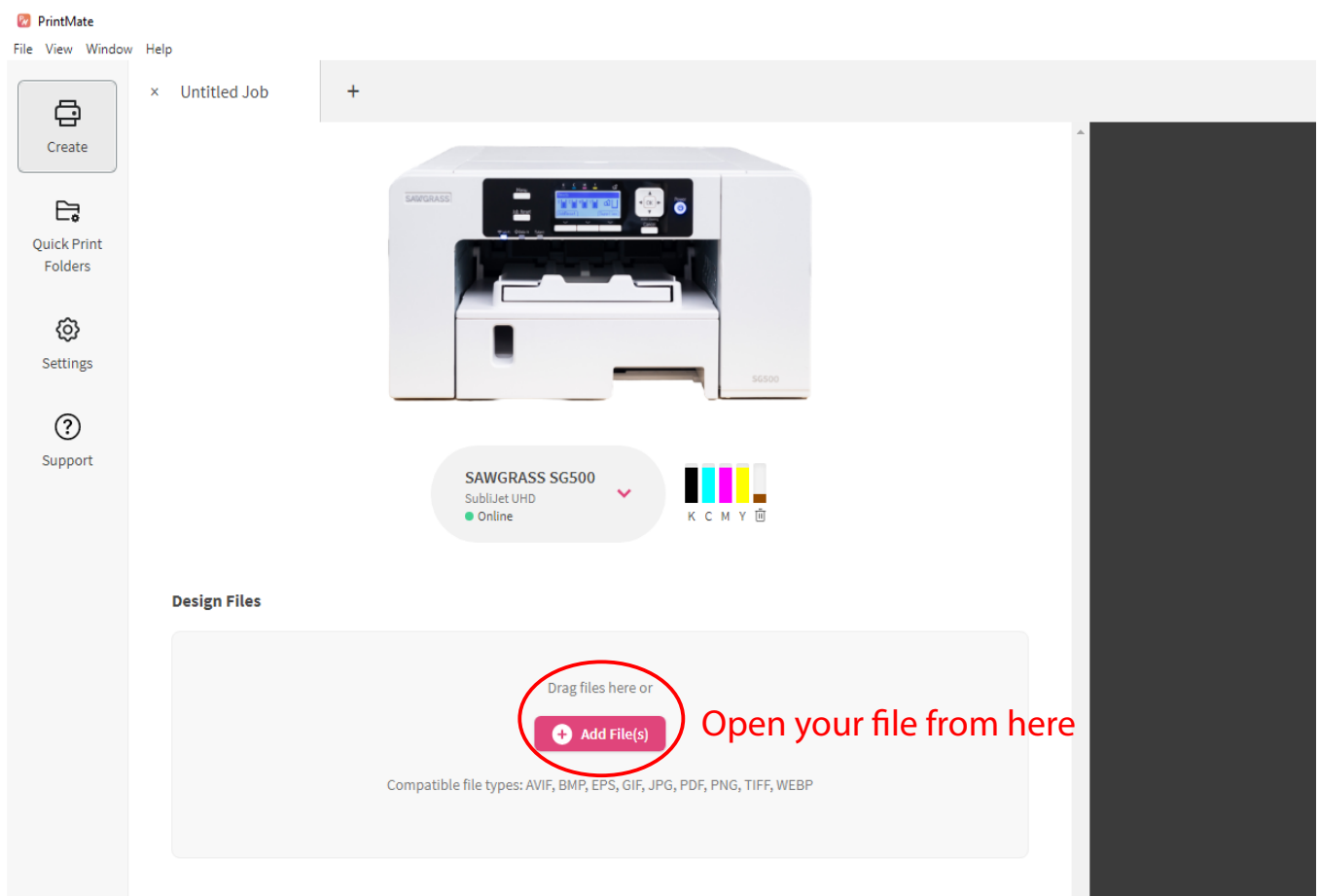



Create



Quick Print  
Folders



Settings



Support

× Untitled Job



SAWGRASS SG500

SubliJet UHD

● Online



## Design Files

Add



Crop to Image Area



undefined-page-1

209.93 x 296.93 mm | 200 dpi

Image will not fit with current paper size selection.

Fit to Paper Size



Width

Height

DPI

Rotation

Spacing

Repeat

209.93 mm



296.93 mm

200



0°



2.54 mm



1



Scroll downwards

## Print Settings

Select a Preset

### General

### Color Management

#### Job Settings

☒ Mirror

☐ Registration Marks

☐ Add Bleed

☒ Center on Page

#### Product

Ceramic

Choose the material where you are pressing to

Acrylic

Ceramic

Glass

HTV

MDF Board

Metal

Neoprene

Polyester

Siser EasySubli HTV

Tumbler

#### Media Size

A4

Choose A4

#### Print Quality

High Quality

#### Media Type

Truepix Classic

#### Media Source

Tray 1

#### Print Orientation

☒ Portrait

☐ Landscape

#### Pages

☒ All

☐ From 1 to 1

Copies 1

Print

Send your job to the printer

- Then cut our prints from paper and tape them to the product with the red tape.
- Then press your product following these instructions.
- After pressing, be aware that products are really hot.



Ceramic mug - max. size 200x80 mm, heat press temp. 180 C°, time 180 sec.

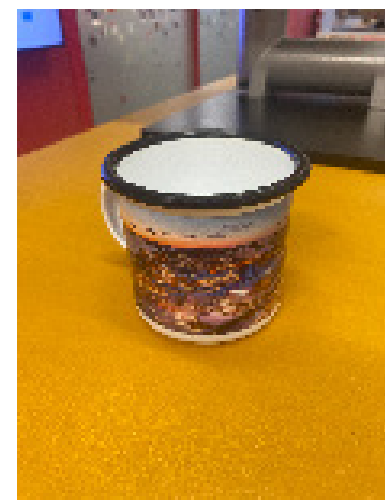
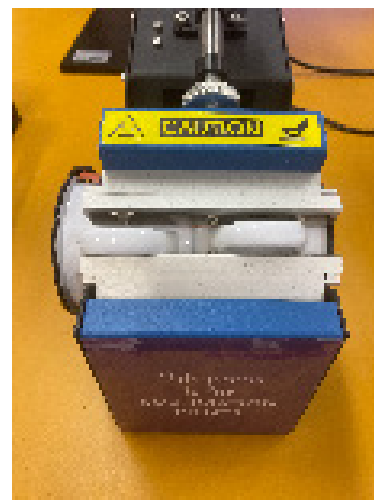

Enamel mug - max. size 200x60 mm, heat press temp. 200 C°, time 275 sec.  
When pressing enamel mug, use another mug to keep pressure even!

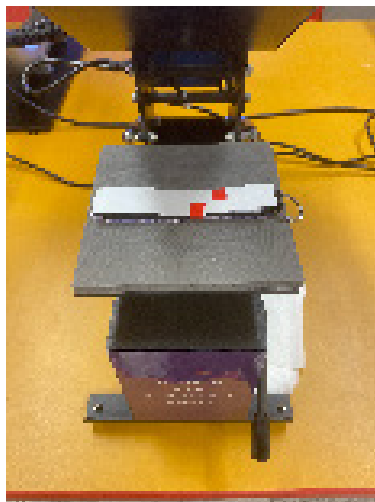

Key chain - actual size 22x125 mm (one side), print size 27x270 mm (both sides), heat press temp. 200 C°, time 40 sec.

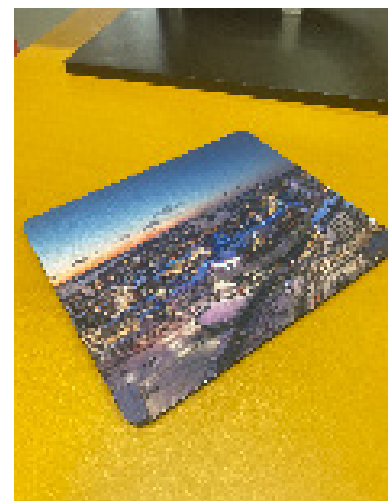
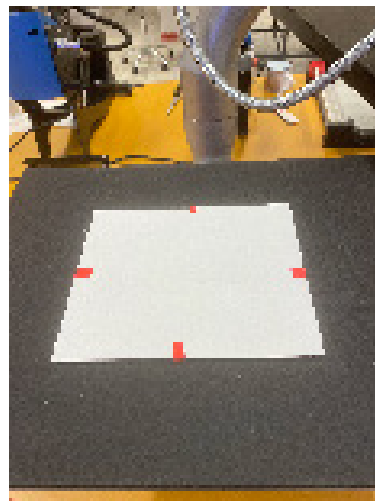
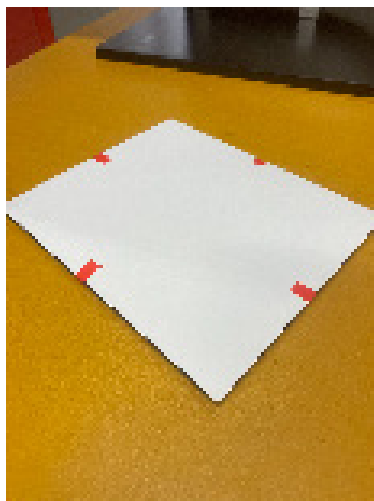

Mouse pad - actual size 228x189 mm, print size 235x195 mm, heat press temp. 200 C°, time 40 sec.

Patch - diameter 80 mm with the border and 75 mm printing area.  
Heat press temp. 200 C°, time 40 sec.

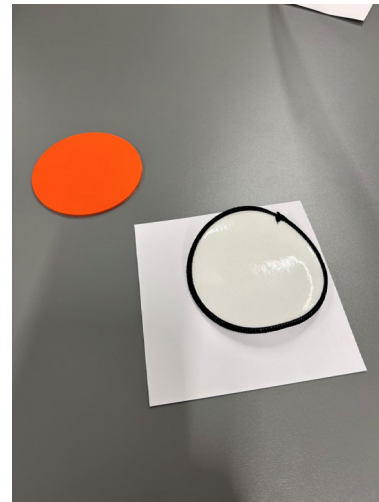

Use these orange rubber plates when pressing the image.  
First place the fabric side of the patch on the picture and  
then place the rubber plate on the patch.

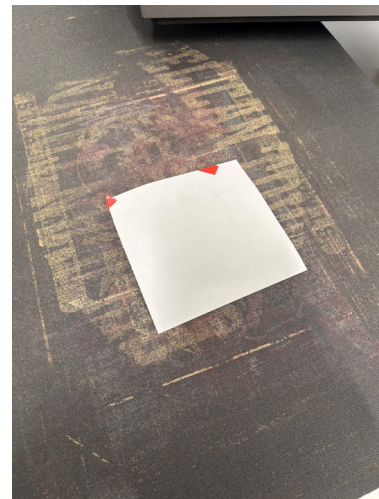

Then use the red tape to attach the set to the paper and  
when placing the set to the press, turn it up side down.



If you are doing multiple patches,  
don't cut them off the paper.  
Tape all the patches and plates to  
the paper and press them at once.

REMEMBER TO PRESS  
THE PAPER SIDE UP!!!!!!